



Ice Shelter Instruction Booklet



Models
69078 Lodge
69057 Pro



MAINTENANCE

THANK YOU . . .

for purchasing an Eskimo® Ice Shelter from Ardisam, Inc. With proper care, your ice shelter will provide many years of service. Please take the time to read this booklet carefully to learn how to correctly assemble your ice shelter. Congratulations on your investment in quality.

SAFETY & MAINTENANCE INSTRUCTIONS

- Do not use open flame heaters in your ice shelter.
- Due to traffic on lakes, ice fishing can be hazardous at night. If you choose to fish at night or in conditions with poor visibility, be sure to take precautions.
- Never leave the ice shelter unattended.
- Lubricate the slide poles with car wax when necessary. Do not use oil or grease as a lubricant.
- Make sure your Eskimo® shelter is completely dry before storing for long periods of time and store your shelter in a cool, dry place away from rodents.

Please fully understand all assembly, safety, and maintenance instructions outlined in this booklet.

1. Undo straps and unfold sled. Lay flat.
2. Tie four 18" rope handles and one 8' tow rope in the holes provided in the **Pro** sled as shown on page 7.
3. Tie six 18" rope handles and one 8' tow rope in the holes provided in the **Lodge** sled as shown on page 6.
4. Unfold canvas and position so the doors are parallel to the hinges of the sled. See Figures 1 & 3.
5. Hook the four (4) longer elastic straps to the "D" rings located in corners of the sled.

NOTE: This will help square the canvas to the base. See Figure 1 & 2.

6. Place elastic bottom edge of canvas around sled.
7. Unzip door and step into shelter on opposite side of laid out poles. Grasp first roof support tube pole and attach (1) velcro strap above the door. Pull poles up evenly until both sides snap in place. See Figures 3 & 4.
8. Grasp center roof support pole, depress bottom snap button on each side to unlock poles and pull up. Raise each side evenly until it snaps in place. See Figures 3 & 4.



Figure 1



Figure 2

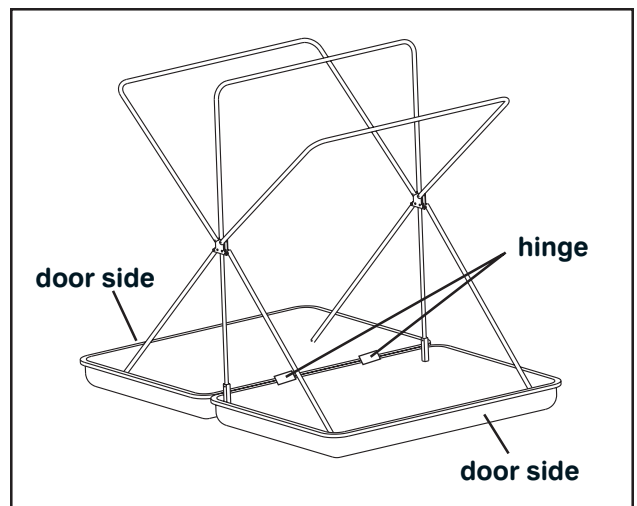

Figure 3

9. Push last roof support pole out evenly until it snaps in place. See Figures 3 & 4. Attach at least (1) velcro strap to each roof pole at all four corners.

NOTE: Make sure canvas is under sled lip and not sled bottom.

10. Go outside of Lodge or Pro, adjust canvas so it is square to the sled and poles are located in the corners of the canvas.
 11. Attach the remaining velcro straps to the roof poles.
 12. Step into each corner to extend poles and tighten thumbscrews. See Figure 5. Center roof support pole should always be in the vertical position. Adjust thumbscrews as needed.
- NOTE: Shorter elastic straps on the bottom of canvas are optional for wind resistance.**
13. For take-down procedures, reverse set-up. **DO NOT** remove the canvas from the poles.

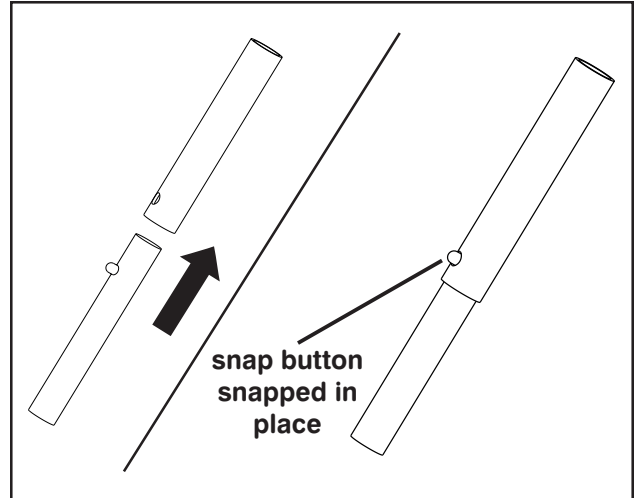
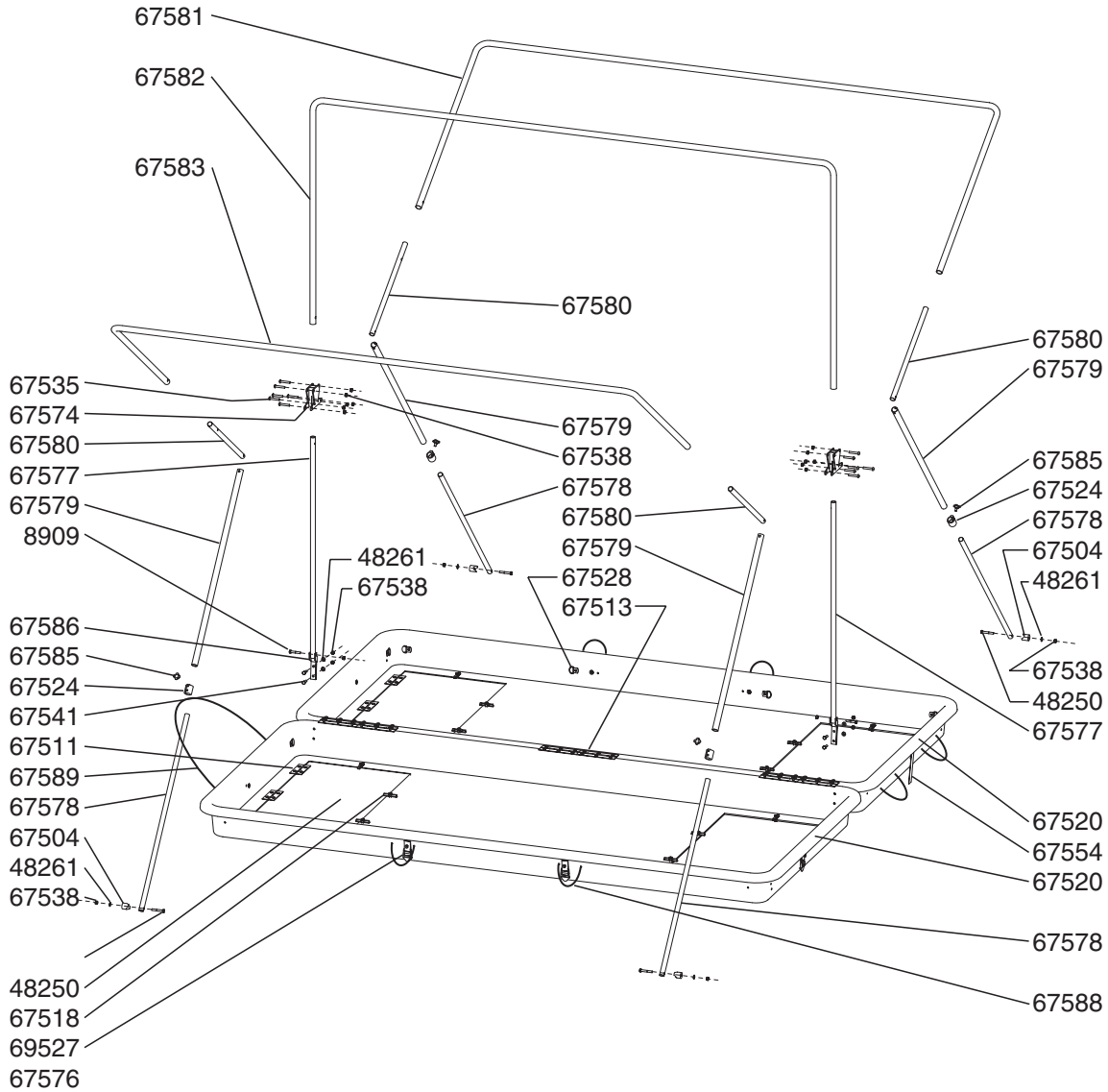

Figure 4

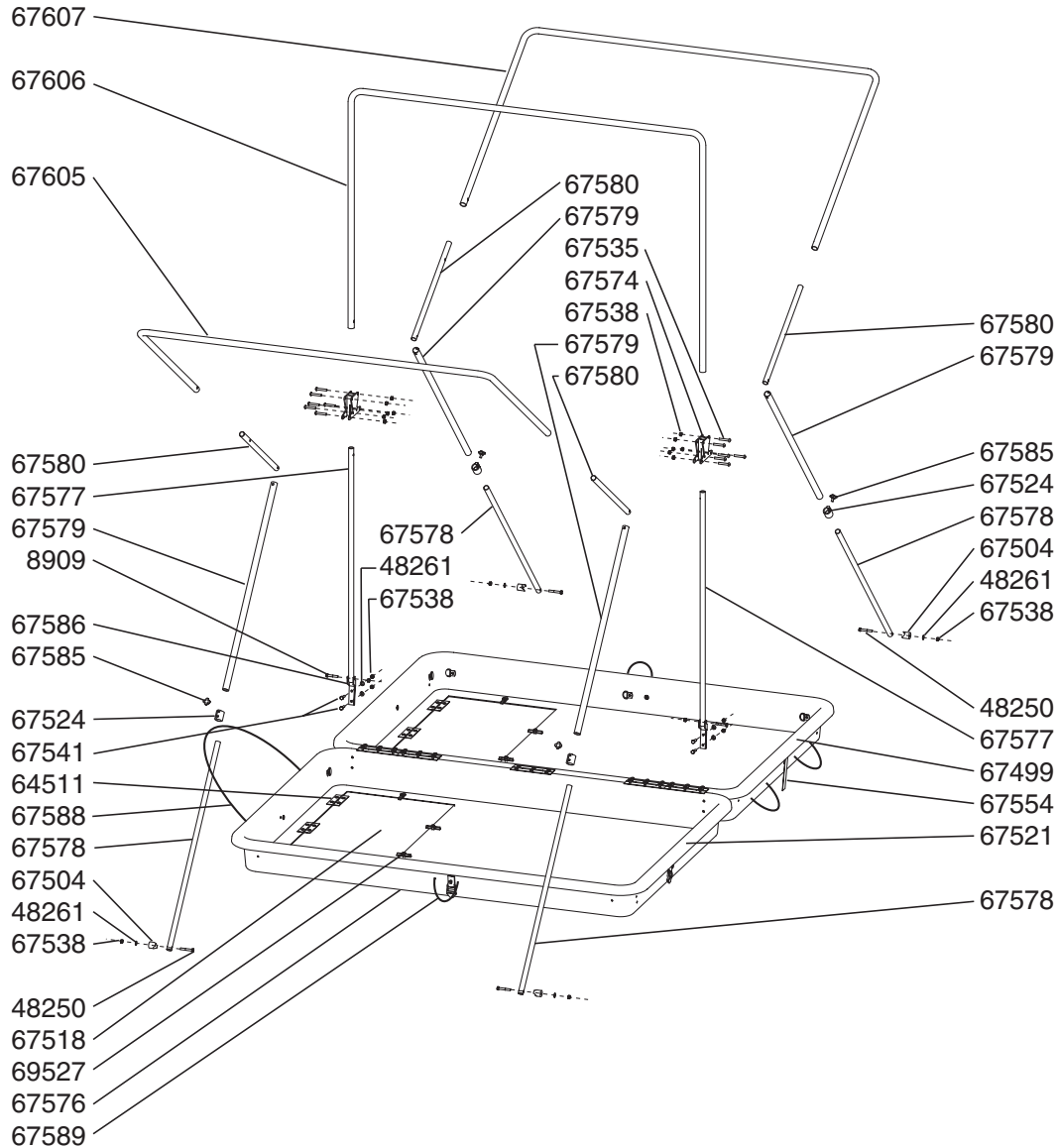

Figure 5

LODGE PARTS EXPLOSION & PARTS LIST



Part #	Description	Qty.	Part #	Description	Qty.
8909	Bolt, 1/4-20 x 1-1/4"	2	67554	Strap, 1"	4
48250	Bolt, 1/4-20 x 1-3/4"	4	67564	Canvas Cover (Not Shown)	1
48261	Flat Washer, 1/4"	8	67574	Sliding Hub	2
53606	Nut, 10-24 Nyloc	16	67576	Buckle Strap Assembly	4
67501	Snap Button	10	67577	Upright Support Pole	2
67504	Stand-off, 1/2"	4	67578	Sled Slide Pole	4
67508	Rivet-Large, Aluminum	4	67579	Sled Receiver Pole	4
67509	Aluminum Backup Washer	44	67580	Roof Slide Pole	4
67510	Rivet, Aluminum	104	67581	Short Corner Roof Pole	1
67511	Hinge-Trap Door, 4"	12	67582	Center Roof Pole	1
67513	Hinge-Sled, 12"	3	67583	Long Corner Roof Pole	1
67518	Trap Door	4	67585	Thumbscrew	4
67520	Lodge Sled	2	67586	Hinge Bracket	2
67524	Slide Pole Joiner	4	67588	Rope Handle	6
67528	"D" Ring	16	67589	Tow Rope	1
67535	Capscrew, Soc Btn, 1/4-20 x 1-1/2"	12	69527	Single Wing Door Latch	16
67536	Bolt-Round Head, 10-24 x 7/8"	16	69531	Window Replacement, 8" x 12"	4
67538	Nut-Nyloc, 1/4-20	22	69534	Window Replacement, 13-1/2" x 13-1/2"	2
67541	Bolt, 1/4-20 x 7/8"	4			



Part #	Description	Qty.	Part #	Description	Qty.
8909	Bolt, 1/4-20 x 1-1/4"	2	67538	Nut-Nyloc, 1/4-20	22
48250	Bolt, 1/4-20 x 1-3/4"	4	67541	Bolt, 1/4-20 x 7/8"	4
48261	Flat Washer, 1/4"	8	67554	Strap, 1"	3
53606	Nut, 10-24 Nyloc	8	67574	Sliding Hub	2
67499	Pro Sled Half	1	67576	Buckle Strap Assembly	3
67501	Snap Button	10	67577	Upright Support Pole	2
67504	Stand-off, 1/2"	4	67578	Sled Slide Pole	4
69527	Single Wing Door Latch	8	67579	Sled Receiver Pole	4
67508	Rivet-Large, Aluminum	3	67580	Roof Slide Pole	4
67509	Aluminum Backup Washer	36	67585	Thumbscrew	4
67510	Rivet, Aluminum	71	67586	Hinge Bracket	2
67511	Hinge-Trap Door, 4"	6	67588	Rope Handle	6
67512	Hinge-Sled, 6"	1	67589	Tow Rope	1
67513	Hinge-Sled, 12"	2	67607	Long Corner Roof Pole	1
67518	Trap Door	2	67608	Center Roof Pole	1
67521	Pro Sled Half	1	67609	Short Corner Roof Pole	1
67524	Slide Pole Joiner	4	67609	Canvas Cover (Not Shown)	1
67528	"D" Ring	16	69531	Window Replacement, 8" x 12"	4
67535	Capscrew, Soc Btn, 1/4-20 x 1-1/2"	12	69534	Window Replacement, 13-1/2" x 13-1/2"	2
67536	Bolt-Round Head, 10-24 x 7/8"	8			

One Year Limited Warranty

The Ardisam, Inc., Manufacturing Company warrants this Eskimo® Ice Shelter to be free from defects in material or workmanship. Conditions of this warranty include:

What is covered under warranty:

Ardisam, Inc. will repair or replace any part defective in workmanship or material within one year after delivery of the ice shelter to the original purchaser.

What is not covered under warranty:

This warranty applies only to products which have not been repaired or altered outside our factory. It does not cover cracked windows, tent tears, or bent poles due to high wind conditions or unattended use. This warranty applies only to the original purchaser, and is not transferrable.

How to obtain service:

Return the product to us at the address below with transportation charges prepaid.

This warranty supersedes all other warranties either expressed or implied and all other obligations or liabilities on our part. Ardisam, Inc., does not assume, and does not authorize any other person to assume for us, any liability in connection with the sale of our products. This guarantee is void unless warranty card is properly filled out and returned to Ardisam, Inc., Cumberland, Wisconsin, at time of purchase.



Ardisam, Inc.
1360 1st Avenue, Cumberland, Wisconsin 54829
Phone (715)822-2415 • Fax (715)822-4180
1-800-345-6007
Email info@ardisam.com
www.ardisam.com