

Congratulations!

You have just purchased the **Yukon Tracks Caribou Large ATV Trailer #AV-110**. Just follow these simple directions for use and your **Caribou Large ATV Trailer** will give you many years of trouble-free pleasure. Save these instructions for future reference.



WARNING! READ AND UNDERSTAND ALL ASSEMBLY, INSPECTION, & USE INSTRUCTIONS PROVIDED BEFORE EACH USE. FAILURE TO FOLLOW INSTRUCTIONS COULD RESULT IN SERIOUS INJURY OR DEATH.

TOOLS NEEDED:

(2) 7/16" wrenches, (2) 1/2" wrenches, 3/16" Allen wrench, 3/4" or 13/16" socket with ratchet and extension, 5/16" drill bit, drill

HARDWARE:

A list of hardware is included on the back page of this booklet.

ASSEMBLY INSTRUCTIONS:

1. Insert the axle tube (TK49) into the rear tongue tube (TK19) until the center hole in the axle tube is in line with the center hole in the tongue tube. Fasten the two pieces together using (1) 5/16-18 x 2-1/4" bolt and (1) 5/16-18 biway locknut. The bolt can face up or down. Tighten the bolt when finished. See Figure 1.
2. Attach the front trailer tongue (TK22) to the rear tongue using (2) 5/16-18 x 4" bolts, (4) 5/16" washers, and (2) 5/16-18 biway locknuts. Make sure that the two tubes are aligned as straight as possible before tightening. Assemble the trailer latch (TK31) to the front tongue with the handle facing the front of the trailer using (4) 1/4-20 x 1/2" socket head cap screws. Tighten all fasteners when finished. See Figure 2.
3. To assemble the axle assemblies and the side tabs, first slide the extra large side tab (TK12) over the small end of the hub and axle assembly (TK51) with the tab angled outward toward the hub. Then insert the small end of the hub and axle assembly into the axle tube. Thread axle into axle tube until tight. Turn back until holes in axle and tube are aligned. Insert a 1/4-20 x 1-3/4" bolt. Fasten using a 1/4-20 locknut. Repeat this for the other side of the trailer frame. Attach the side tabs to the frame (TK14) using (4) 5/16-18 x 1-3/4" bolts, (4) 5/16" washers and (4) 5/16-18 biway locknuts. See Figures 3 and 4.
4. Support the trailer so that the hub is far enough off of the ground that the tire and wheel assembly (TK28) will fit onto the studs on the hub. Rotate the wheel or the hub until the studs are aligned with the hole pattern in the wheel. Tighten using (4) 1/2-20 UNF lug nuts (TK44) per wheel. See Figure 5.
5. Assemble the front tabs (TK13) with the small flat of the tab flat against the frame and the tab angled forward using (4) 5/16-18 x 1-3/4" bolts, (4) 5/16 washers and (4) 5/16-18 biway locknuts. Tighten nuts bolts. See Figure 6 and Figure 7.
6. Lay the plastic tub (67900) inside of the trailer frame and make sure that it is tight against the sides, front, and bottom of the frame. Using a 5/16" drill and the upper holes of the (4) tabs (TK12 and TK13) as guides, drill (8) holes in the plastic tub. Secure the tub to the frame with (8) 5/16-18 x 1" bolts, (8) 5/16" washers, and (8) 5/16-18 biway locknuts. Ensure that the tub does not move while you are drilling. When a hole is finished, insert a 5/16-18 x 1" bolt with a 5/16" washer to hold the tub in place. See Figure 8.

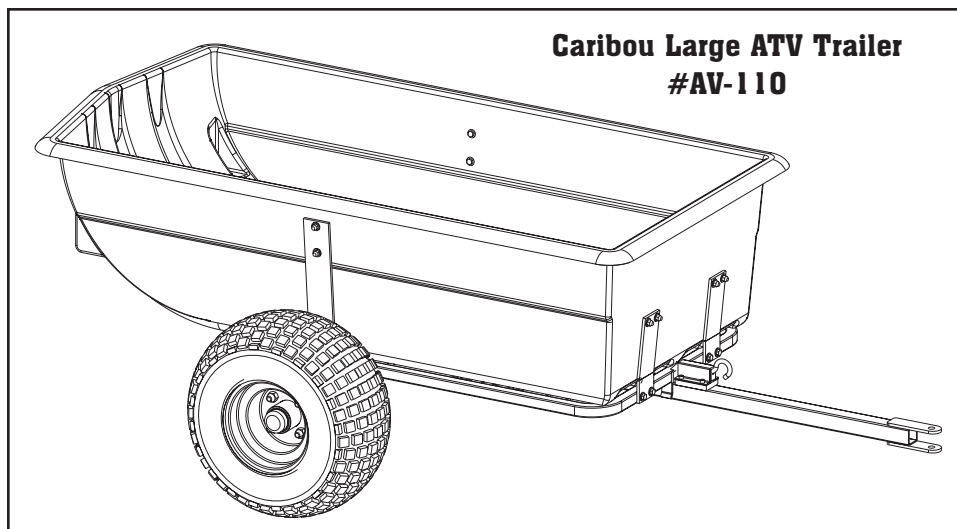

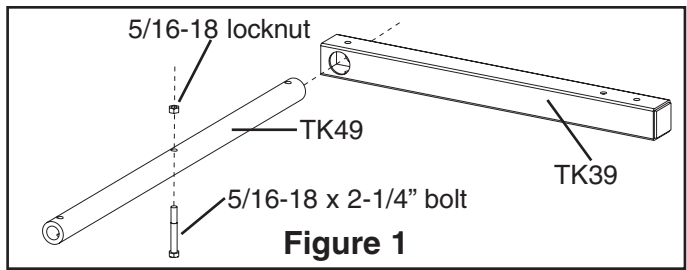

Figure 1

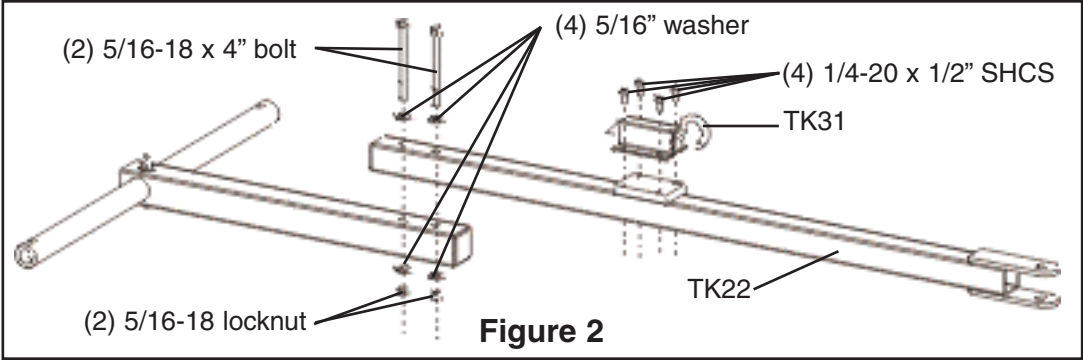

Figure 2

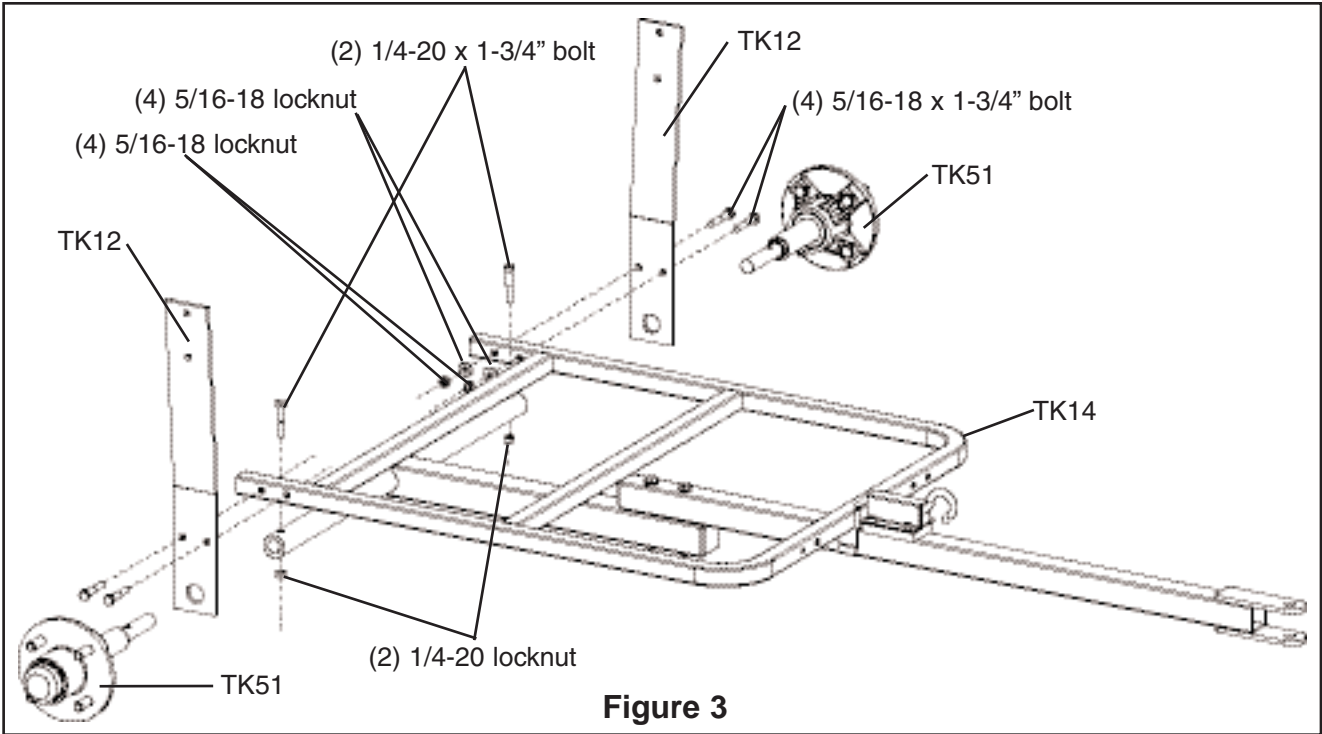

Figure 3

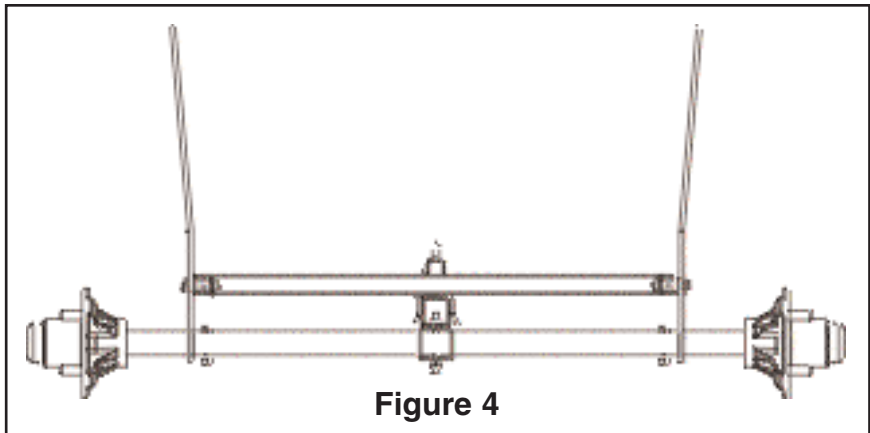
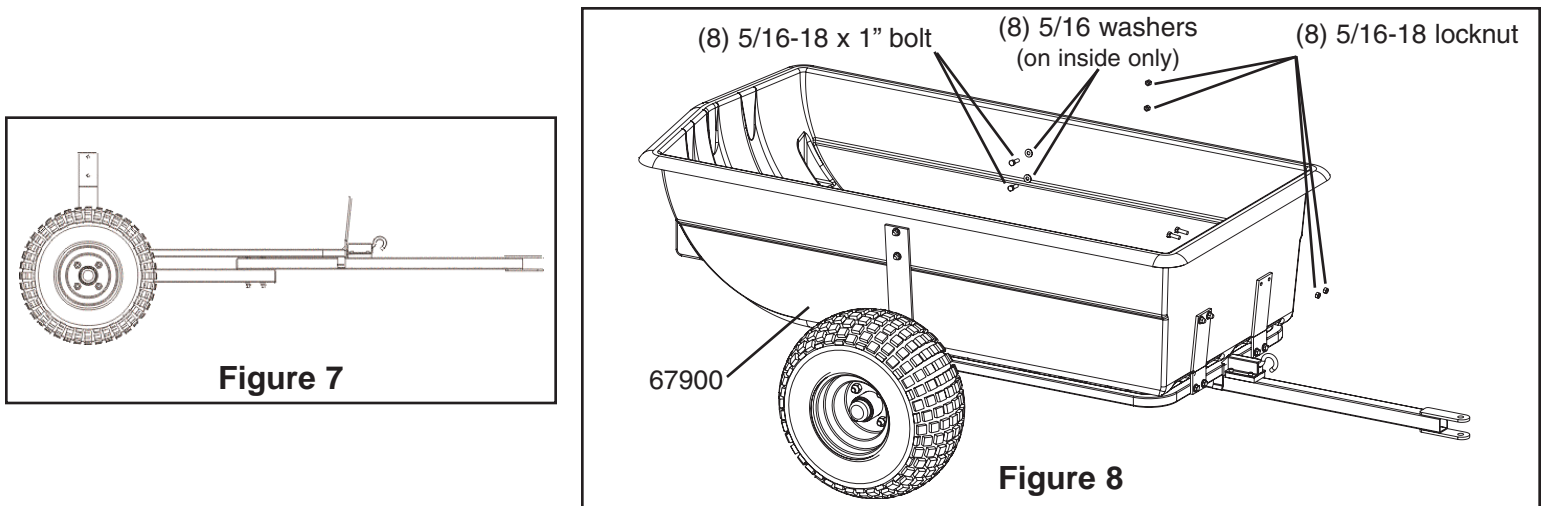
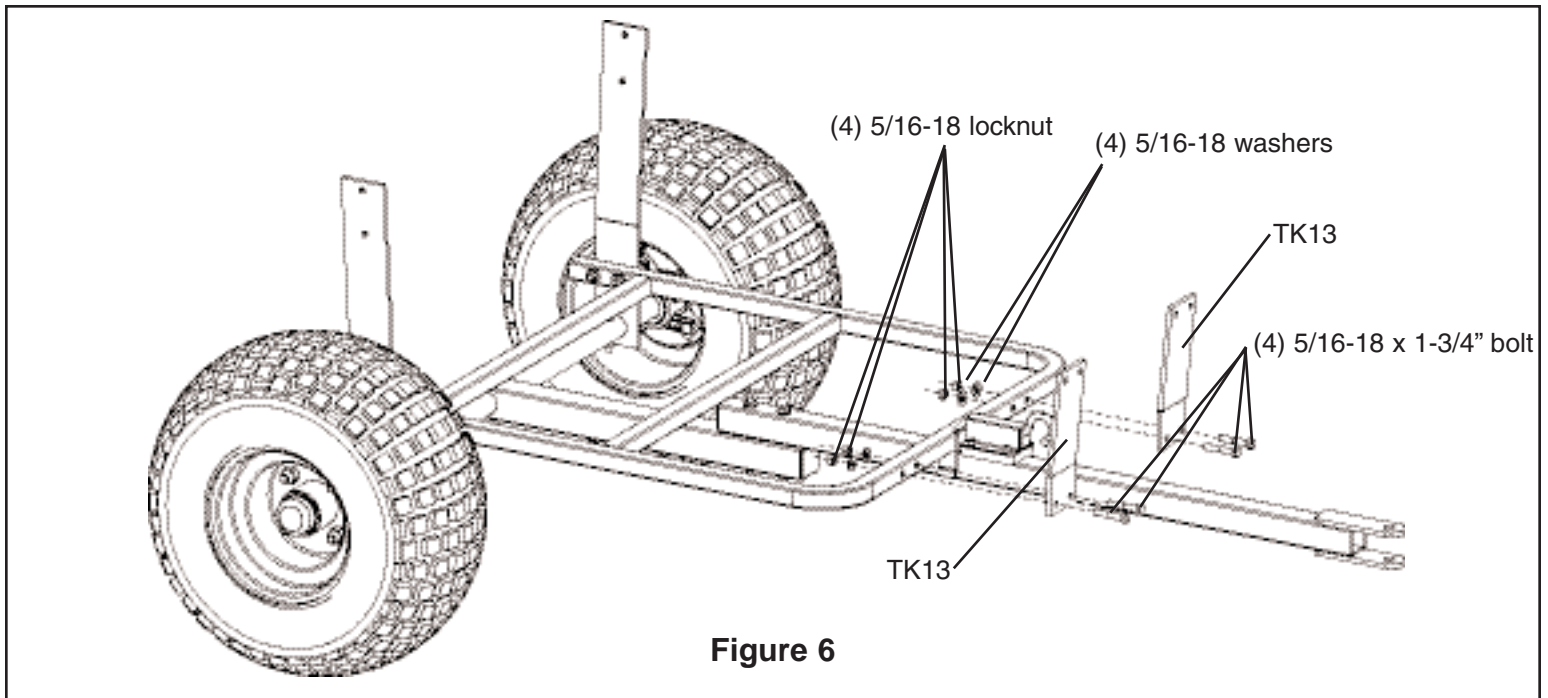
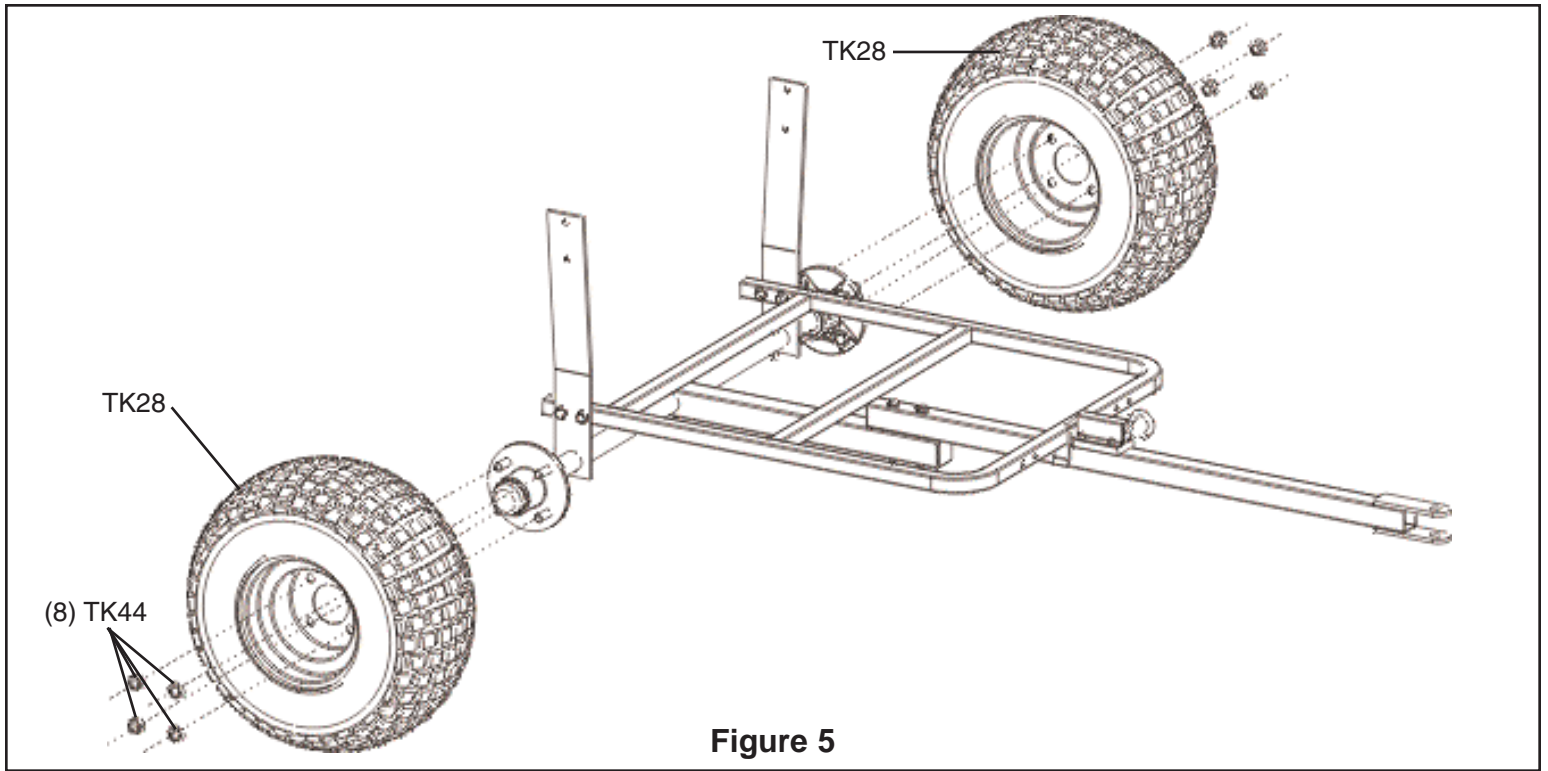

Figure 4



USE INSTRUCTIONS:



WARNING! CHECK THE ASSEMBLY OF YOUR TRAILER TO BE SURE YOU ASSEMBLED IT CORRECTLY AND ALL NUT/BOLT ASSEMBLIES ARE TIGHT BEFORE INITIAL USE. LUG NUTS AND ALL NUT/BOLT ASSEMBLIES SHOULD BE CHECKED FREQUENTLY TO BE SURE THAT NONE HAVE BECOME LOOSE DURING USE. BE SURE THE TRAILER TILT LATCH IS ENGAGED BEFORE EACH USE.

1. Always tow this trailer in a safe and responsible manner and at speeds less than 20 mph.



WARNING! NEVER EXCEED A 20 MPH SPEED WHEN TOWING THE TRAILER.



WARNING! READ AND UNDERSTAND ALL ASSEMBLY, INSPECTION AND USE INSTRUCTIONS PROVIDED BEFORE EACH USE. FAILURE TO FOLLOW INSTRUCTIONS COULD RESULT IN SERIOUS INJURY OR DEATH.



WARNING! READ AND UNDERSTAND ALL INSTRUCTIONS BEFORE USE. IF ANY INSTRUCTIONS ARE NOT UNDERSTOOD OR IF YOU HAVE A PARTS ISSUE CALL 715-822-2415 BEFORE USING.

- ◆ Never use an ATV while under the influence of alcohol or drugs.
- ◆ Never exceed a 20 mph speed when towing this trailer.
- ◆ Never exceed the maximum weight capacity of 1390 lbs.
- ◆ Never allow people or animals to ride in this trailer.
- ◆ Never use on uneven terrain or side hills.
- ◆ Never use on rocky or obstacle ridden terrain.
- ◆ Never use a damaged product.
- ◆ Never use in a careless manner - think safety!
- ◆ Use as a 4-wheeled ATV trailer only.
- ◆ Be sure the trailer is securely attached to ATV hitch.
- ◆ Be sure the tires have the correct air pressure.



(4) 1/4-20 x 1/2" Socket Head Cap Screw



(2) 1/4-20 x 1 3/4" Bolt



(8) 5/16-18 x 1" Bolt

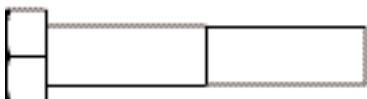

(8) 5/16 x 18 x 1-3/4" Bolt



(1) 5/16-18 x 2-1/4" Bolt



(2) 5/16-18 x 4" Bolt



(8) 1/2-20 UNF Lug Nut



(22) 5/16" Washer



(19) 5/16-18 Biway Locknut



(2) 1/4-20 Locknut



YUKON TRACKS

Division of Ardisam, Inc.
1690 Elm Street, PO Box 666
Cumberland, WI 54829
(715) 822-2415 Fax (715) 822-4180